

## VU52; VU53 Two-way Fan Coil Valves



Two-way Fan Coil Valves, the VU53 high pressure zone valves are used to control the flow of hot or chilled water in commercial HVAC equipment such as fan coil units, terminal reheat coils and convectors. **IMPORTANT** These valves are not for use in systems containing dissolved oxygen.

- Compact construction for easy installation
- Fits under the cover of most baseboard convectors with actuator fitted to valve body
- VU52 and VU53 provide 2-way, straight-through control of water
- Available in normally closed (VU53) or normally open (VU52) configurations
- 300 psi (2,000 kPa, PN20) operating pressure rating
- Patented ball seal provides long service life, soft close off
- Triple O-ring seal provides three lines of defense against corrosion and water leakage around drive shaft
- Quick opening flow curve
- Available with NPT end connections for iron or steel piping

### Dimensions in inches (millimeters)

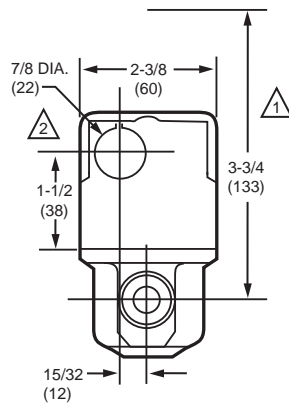

VU53 VALVE WITH VU448 ACTUATOR

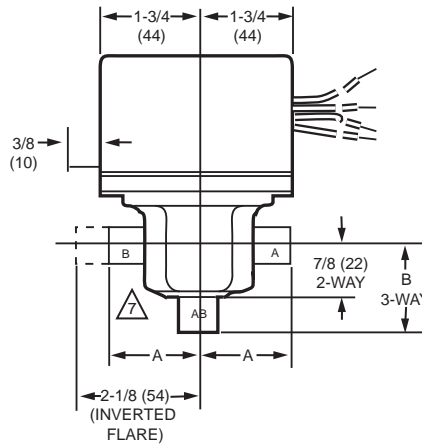

VU53 AND VU54 VALVE WITH ACTUATOR

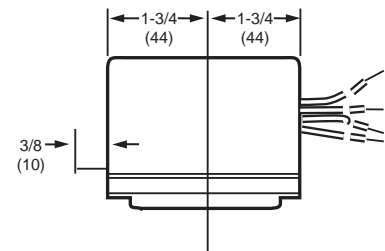

VU5 ACTUATOR

- △1 HEIGHT NEEDED TO REMOVE ACTUATOR OR COVER
- △2 OPENING FOR 1/2 IN. CONDUIT ON OPPOSITE SITE OF MANUAL LEVER FOR ALL MODELS.

VALVE BODY SIZE	A	B
1/2 IN. SWEAT	1 5/6 (33)	1 5/6 (33)
3/4 IN. SWEAT	1 3/8 (35)	1 11/16 (43)
1 IN. SWEAT	1 11/16 (43)	1 11/16 (43)
1/2 IN. NPT	1 3/8 (35)	1 5/16 (33)
3/4 IN. NPT	1 11/16 (43)	1 7/16 (37)
1 IN. NPT	1 11/16 (43)	1 7/16 (37)

M18261A

**Valve Type:** Fan Coil Valve

**Actuation:** Must be purchased separately

**Flow Characteristics:** Quick opening

**Body Pattern:** Two-way, Straight-through

**Controlled Medium:** Chilled or hot water with up to 60% Glycol

**Maximum Safe Operating Pressure:** 300 psig (2068 kPa)

**Ambient Temperature Range:** 34 F to 125 F at 200 F Fluid  
(1 to 52 C @ 94 C Fluid)

**Materials**

**(Body):** Brass

**(Stem):** Brass

**(Seat):** Brass

**(Plug/Ball/Disc):** Bun a-N rubber

**(Packing):** EPDM rubber

**Approvals**

**Canadian Standards Association:** CSA C/US

# Fan Coil Valves

Product Number	Valve Size		Flow Capacity		Dimensions, A to B ports End to End		Dimensions, Center Line of A&B port to end of AB port		Connection Type	Valve Action	Maximum Close-off Pressure		Used With
	(inch)	DN	(Cv)	(Kv)	(inch)	(mm)	(inch)	(mm)			(psi)	(kPa)	
VU52N1001/U	3/4 in.	DN20	8.0 Cv	7.0 kvs	3 3/8 in.	86 mm	1 11/16 in.	43 mm	Female NPT	Normally Open	10 psi	69 kPa	VU444 Actuator, VU844 Actuator
VU52N1019/U	1/2 in.	DN15	3.5 Cv	3.0 kvs	2 3/4 in.	70 mm	1 3/8 in.	35 mm	Female NPT	Normally Open	20 psi	138 kPa	VU444 Actuator, VU844 Actuator
VU52N1027/U	1/2 in.	DN15	1.0 Cv	0.9 kvs	2 3/4 in.	70 mm	1 3/8 in.	35 mm	Female NPT	Normally Open	50 psi	345 kPa	VU444 Actuator, VU844 Actuator
VU52N1035/U	1/2 in.	DN15	2.4 Cv	2.1 kvs	2 3/4 in.	70 mm	1 3/8 in.	35 mm	Female NPT	Normally Open	30 psi	207 kPa	VU444 Actuator, VU844 Actuator
VU52S2002/U	1/2 in.	DN15	1.0 Cv	0.9 kvs	2 5/8 in.	66 mm	1 5/16 in.	33 mm	Sweat	Normally Open	50 psi	345 kPa	VU444 Actuator, VU844 Actuator
VU52S2010/U	1/2 in.	DN15	2.4 Cv	2.1 kvs	2 5/8 in.	66 mm	1 5/16 in.	33 mm	Sweat	Normally Open	30 psi	207 kPa	VU444 Actuator, VU844 Actuator
VU52S2028/U	1/2 in.	DN15	3.5 Cv	3.0 kvs	2 5/8 in.	66 mm	1 5/16 in.	33 mm	Sweat	Normally Open	20 psi	138 kPa	VU444 Actuator, VU844 Actuator
VU52S2036/U	3/4 in.	DN20	3.5 Cv	3.0 kvs	2 3/4 in.	70 mm	1 3/8 in.	35 mm	Sweat	Normally Open	20 psi	138 kPa	VU444 Actuator, VU844 Actuator
VU52S2044/U	3/4 in.	DN20	5.0 Cv	4.3 kvs	2 3/4 in.	70 mm	1 3/8 in.	35 mm	Sweat	Normally Open	15 psi	103 kPa	VU444 Actuator, VU844 Actuator
VU52S2051/U	3/4 in.	DN20	8.0 Cv	7.0 kvs	2 3/4 in.	70 mm	1 3/8 in.	35 mm	Sweat	Normally Open	10 psi	69 kPa	VU444 Actuator, VU844 Actuator
VU53N1009/U	1/2 in.	DN15	3.5 Cv	3.0 kvs	2 3/4 in.	70 mm	1 3/8 in.	35 mm	Female NPT	Normally Closed	20 psi	138 kPa	VU443 Actuator, VU843 Actuator
VU53N1017/U	3/4 in.	DN20	8.0 Cv	7.0 kvs	3 3/8 in.	86 mm	1 11/16 in.	43 mm	Female NPT	Normally Closed	10 psi	69 kPa	VU443 Actuator, VU843 Actuator
VU53N1026/U	1 in.	DN25	8.0 Cv	7.0 kvs	—	—	—	—	Female NPT	Normally Closed	10 psi	69 kPa	VU443 Actuator, VU843 Actuator
VU53N1033/U	3/4 in.	DN20	3.5 Cv	3.0 kvs	3 3/8 in.	86 mm	1 11/16 in.	43 mm	Female NPT	Normally Closed	20 psi	138 kPa	VU443 Actuator, VU843 Actuator
VU53N1041/U	1/2 in.	DN15	1.0 Cv	0.9 kvs	2 3/4 in.	70 mm	1 3/8 in.	35 mm	Female NPT	Normally Closed	50 psi	345 kPa	VU443 Actuator, VU843 Actuator
VU53N1058/U	1/2 in.	DN15	2.4 Cv	2.1 kvs	—	—	—	—	Female NPT	Normally Closed	30 psi	207 kPa	VU443 Actuator, VU843 Actuator
VU53N1066/U	3/4 in.	DN20	5.0 Cv	4.3 kvs	3 3/8 in.	86 mm	1 11/16 in.	43 mm	Female NPT	Normally Closed	15 psi	103 kPa	VU443 Actuator, VU843 Actuator
VU53S2000/U	1 in.	DN25	8.0 Cv	7.0 kvs	3 3/8 in.	86 mm	1 11/16 in.	43 mm	Sweat	Normally Closed	10 psi	69 kPa	VU443 Actuator, VU843 Actuator
VU53S2018/U	1/2 in.	DN15	1.0 Cv	0.9 kvs	2 5/8 in.	66 mm	1 5/16 in.	33 mm	Sweat	Normally Closed	50 psi	345 kPa	VU443 Actuator, VU843 Actuator
VU53S2026/U	1/2 in.	DN15	2.4 Cv	2.1 kvs	2 5/8 in.	66 mm	1 5/16 in.	33 mm	Sweat	Normally Closed	30 psi	207 kPa	VU443 Actuator, VU843 Actuator
VU53S2034/U	1/2 in.	DN15	3.5 Cv	3.0 kvs	2 5/8 in.	66 mm	1 5/16 in.	33 mm	Sweat	Normally Closed	20 psi	138 kPa	VU443 Actuator, VU843 Actuator
VU53S2042/U	3/4 in.	DN20	3.5 Cv	3.0 kvs	2 3/4 in.	70 mm	1 3/8 in.	35 mm	Sweat	Normally Closed	20 psi	138 kPa	VU443 Actuator, VU843 Actuator
VU53S2059/U	3/4 in.	DN20	8.0 Cv	7.0 kvs	2 3/4 in.	70 mm	1 3/8 in.	35 mm	Sweat	Normally Closed	10 psi	69 kPa	VU443 Actuator, VU843 Actuator
VU53S2075/U	3/4 in.	DN20	5.0 Cv	4.3 kvs	2 3/4 in.	70 mm	1 3/8 in.	35 mm	Sweat	Normally Closed	15 psi	103 kPa	VU443 Actuator, VU843 Actuator